

|   |   |   |   |   |   |   |   |
|---|---|---|---|---|---|---|---|
| 1 | 2 | 3 | 4 | 5 | 6 | 7 | 8 |
|---|---|---|---|---|---|---|---|

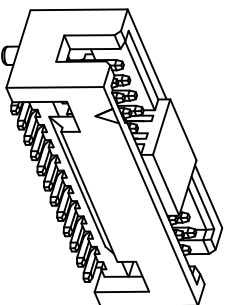

**Current Rating:** 1 Amps  
**Insulator Resistance:** 1000 Megohms min  
**Contact Resistance:** 20m ohms max.  
**Dielectric Withstanding:** AC 500V  
**Operating Temperature:** -40° ~ +105° C  
**Max Processing Temp:** 230° C for 60 seconds  
**Contact Material:** 260° C for 10 seconds  
**Insulator Material:** Brass  
**Finish:** Polyester, UL 94V-0  
**Standard:** Gold Plated PA6T

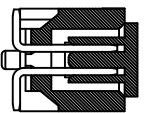
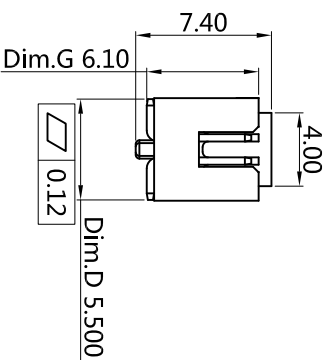
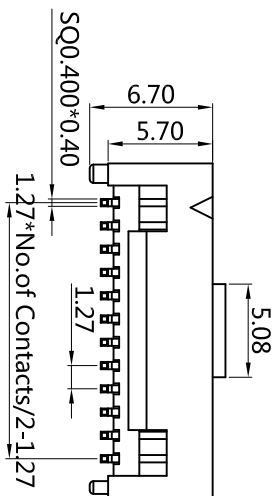
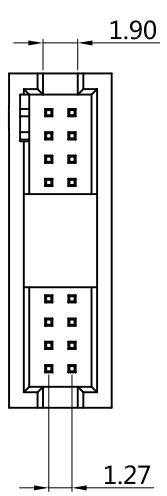
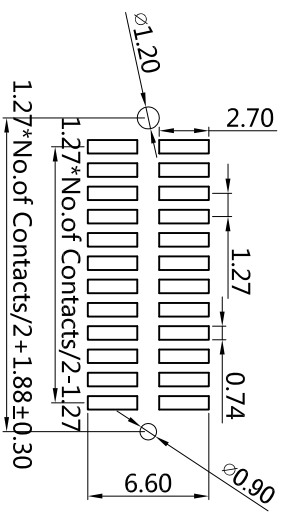
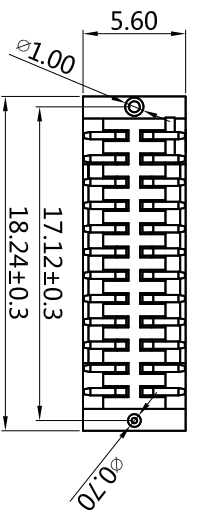

Recommended P.C. Board  
 Hole Layout

BH31 X - XX D1 BK X 001 E  
 1 2 3 4 5 6 7

**1. Insulator Material:**  
 N=PA6T  
 L=LCF P=PA9T

**2. Circuits:** 08-100pin  
**3. Tail Style**

**D1=SMT** belt column  
**4. Color:** BK=Black

**5. Contact Plated:**  
 T=Matte tin over nickel  
 W=Matte tin over nickel 150µ"  
 Y=Brighe tin over nickel

**6. Special Options**  
 I=Gold 1µ"  
 E=Gold 5µ", Ni 50 µ"  
 G=Gold 10µ"  
 J=Gold 10µ", Ni 50 µ"  
 L=Gold 15 µ"  
 M=Gold 15 µ", Ni 50 µ"  
 U=Gold 30 µ"  
 V=Gold 30 µ", Ni 50 µ"  
 N=Gold flash, NI

**7. Packing**  
 B=Tube  
 C=Tray  
 D=Box  
 E=Cap+tap&reel  
 N=Tap&reel



东莞市震升电子有限公司  
 DONG GUAN ZHEN SHENG ELECTRONICS CO., LTD

|     |                    |             |                   |             |            |            |
|-----|--------------------|-------------|-------------------|-------------|------------|------------|
| BOM | 1: BH31P-60BKHC4   | PART NO.    | BH31X-XXD1BKX001E | X           | .XX        | .XXX       |
|     | 2: SQ0.4-7.4-X-C12 | DRAWING NO  | ZS-00145-J        | ±0.30       | ±0.20      | ±0.1       |
|     | 3:                 | DRAWN BY    | Deng jin quan     | EDITION: A1 | SCALE: 1:1 | ITEM: BH31 |
|     |                    | APPROVAL BY | Chen xiao guang   | 2022-11-15  | UNIT: M.M  |            |

TEL: 0769-85305015 FAX: 0769-85845060

|   |   |   |   |   |   |
|---|---|---|---|---|---|
| F | E | D | C | B | A |
|---|---|---|---|---|---|